

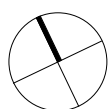

Einrichtung: Klassenzimmer

Max. 18-20 Personen

Massstab/Format 1:100 | A4
Plannummer 163.1
Datum 25.06.2020
Gezeichnet LL



 Tisch = 150x70cm
 Stuhl = 45x45cm

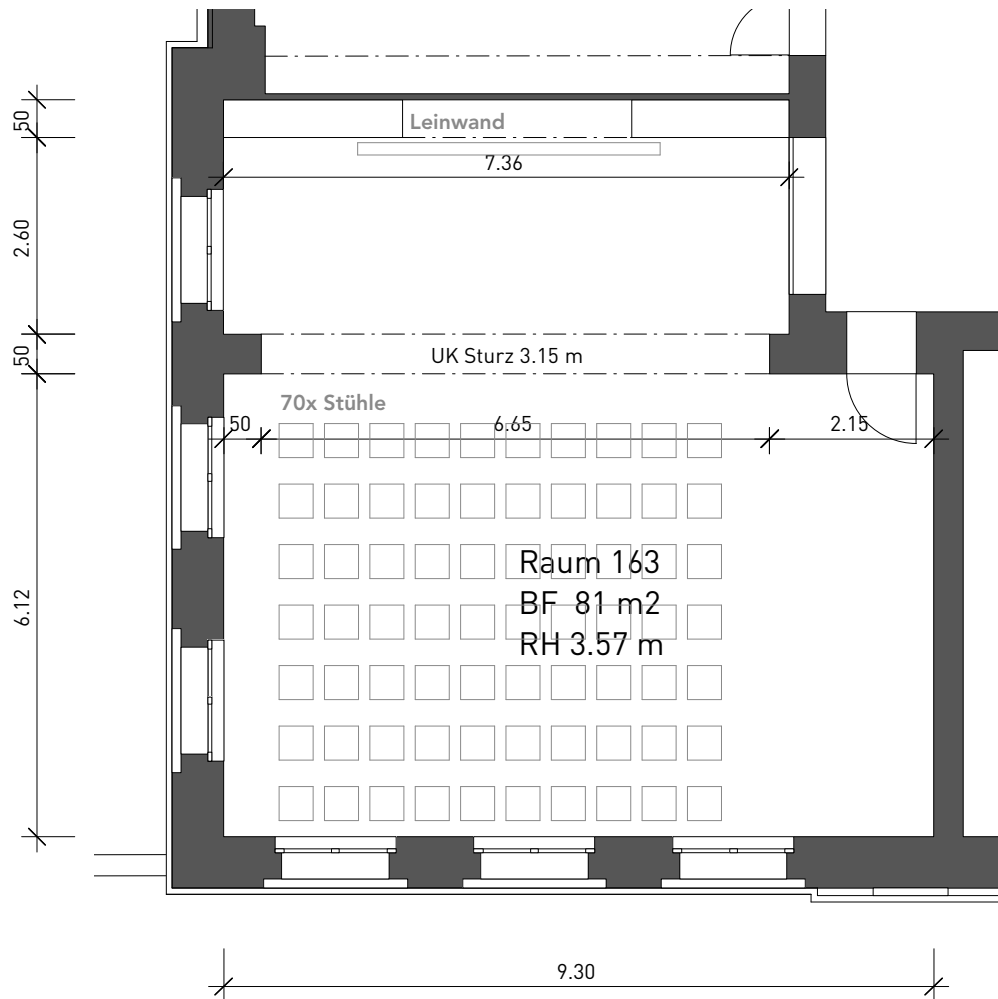

Einrichtung: Theaterbestuhlung

Max. 70 Personen

Massstab/Format 1:100 | A4
Plannummer 163.1
Datum 25.06.2020
Gezeichnet LL

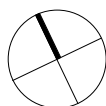

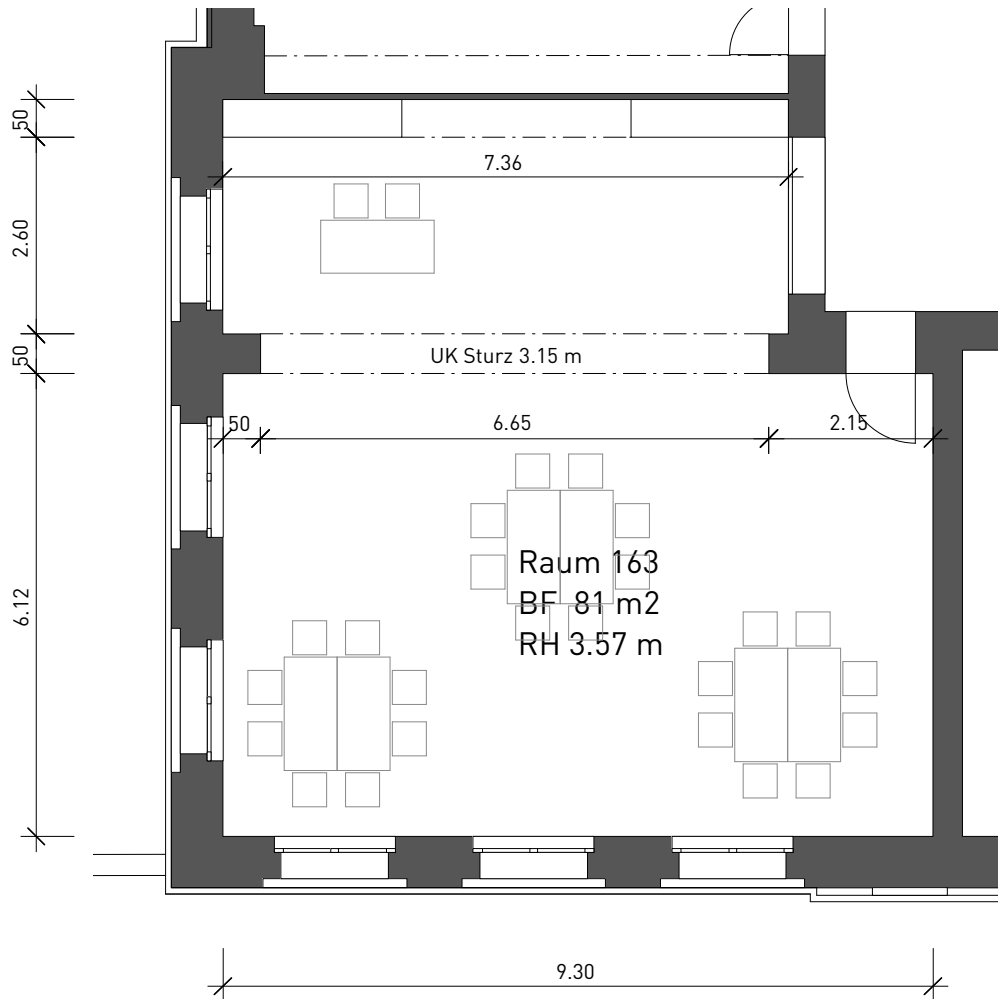

Einrichtung: Tischinseln

Max. 24-32 Personen

Massstab/Format 1:100 | A4
Plannummer 163.1
Datum 25.06.2020
Gezeichnet LL

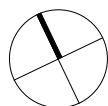

Tisch = 150x70cm
Stuhl = 45x45cm

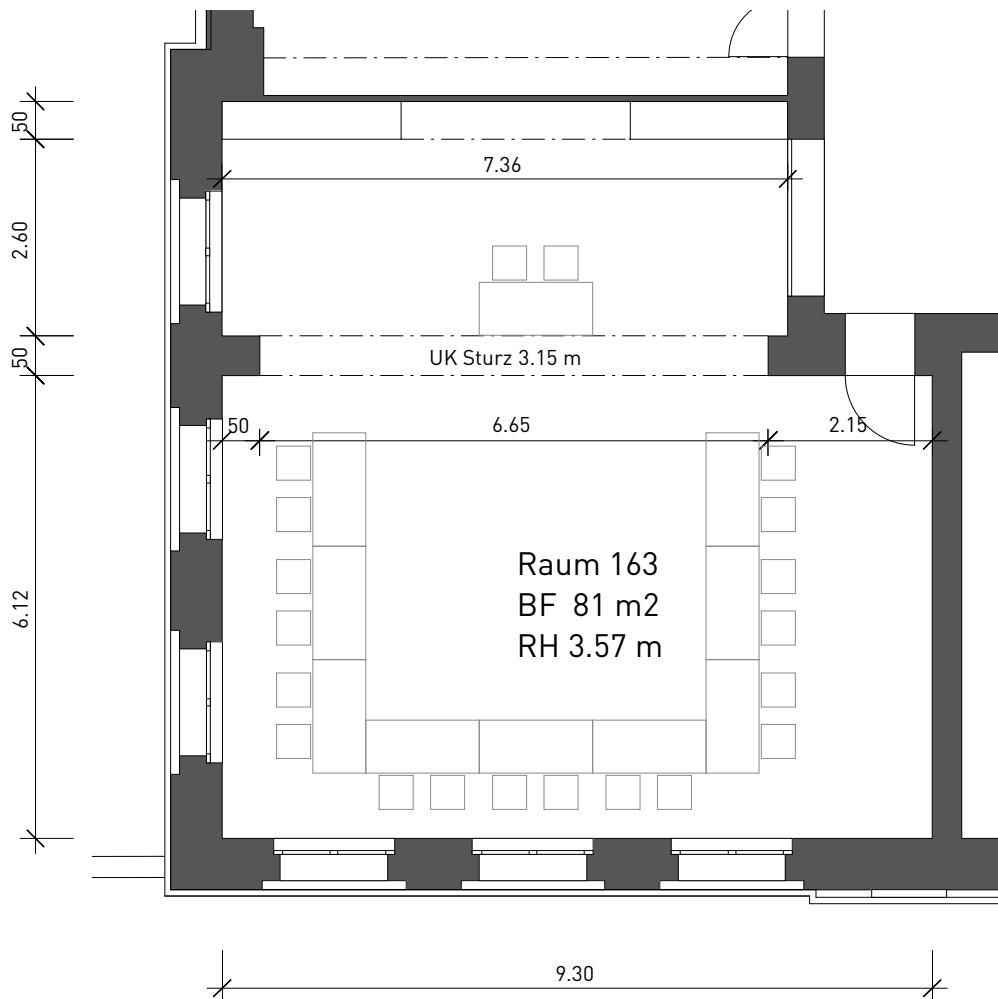

Einrichtung: U-Form

Max. 20 Personen

Massstab/Format 1:100 | A4
Plannummer 163.1
Datum 25.06.2020
Gezeichnet LL

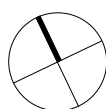

Tisch = 150x70cm
Stuhl = 45x45cm