

Einrichtung: Klassenzimmer
Max. 50-60 Personen

Massstab/Format 1:100 | A4
Plannummer 168.1
Datum 25.06.2020
Gezeichnet LL

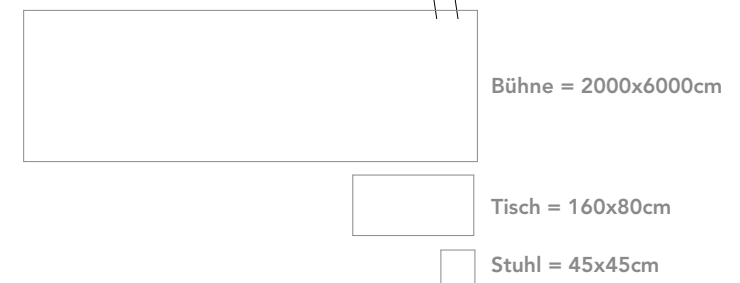

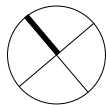
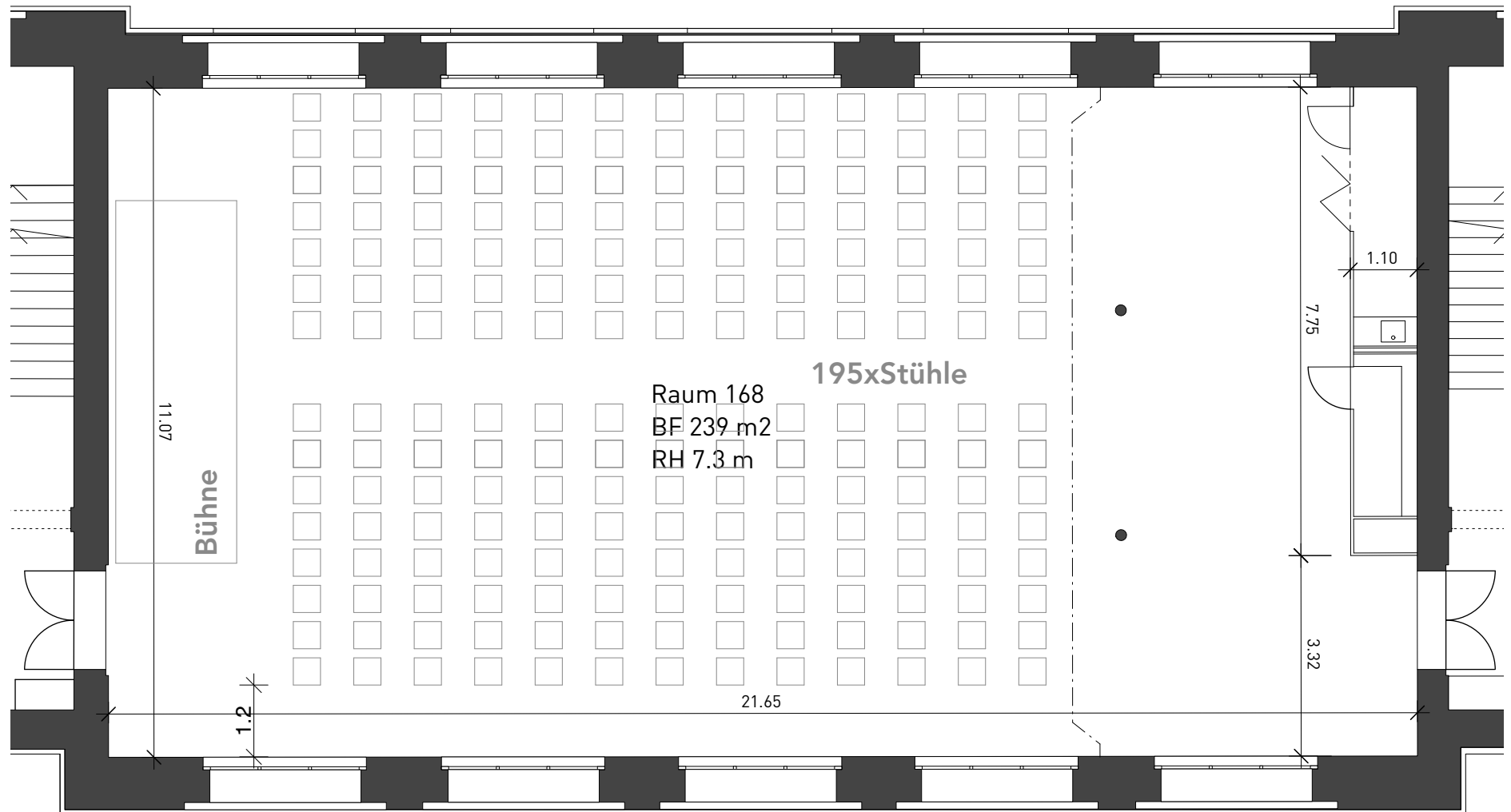

Einrichtung: Theaterbestuhlung

Max. 200 Personen / inkl. Galerie 250 Personen

Masstab/Format 1:100 | A4
Plannummer 168.1
Datum 25.06.2020
Gezeichnet LL

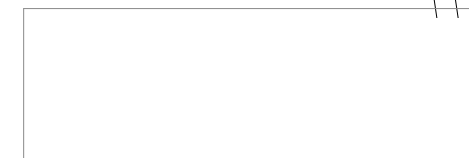
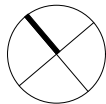

Bühne = 2000x6000cm



Tisch = 160x80cm

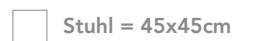

Stuhl = 45x45cm

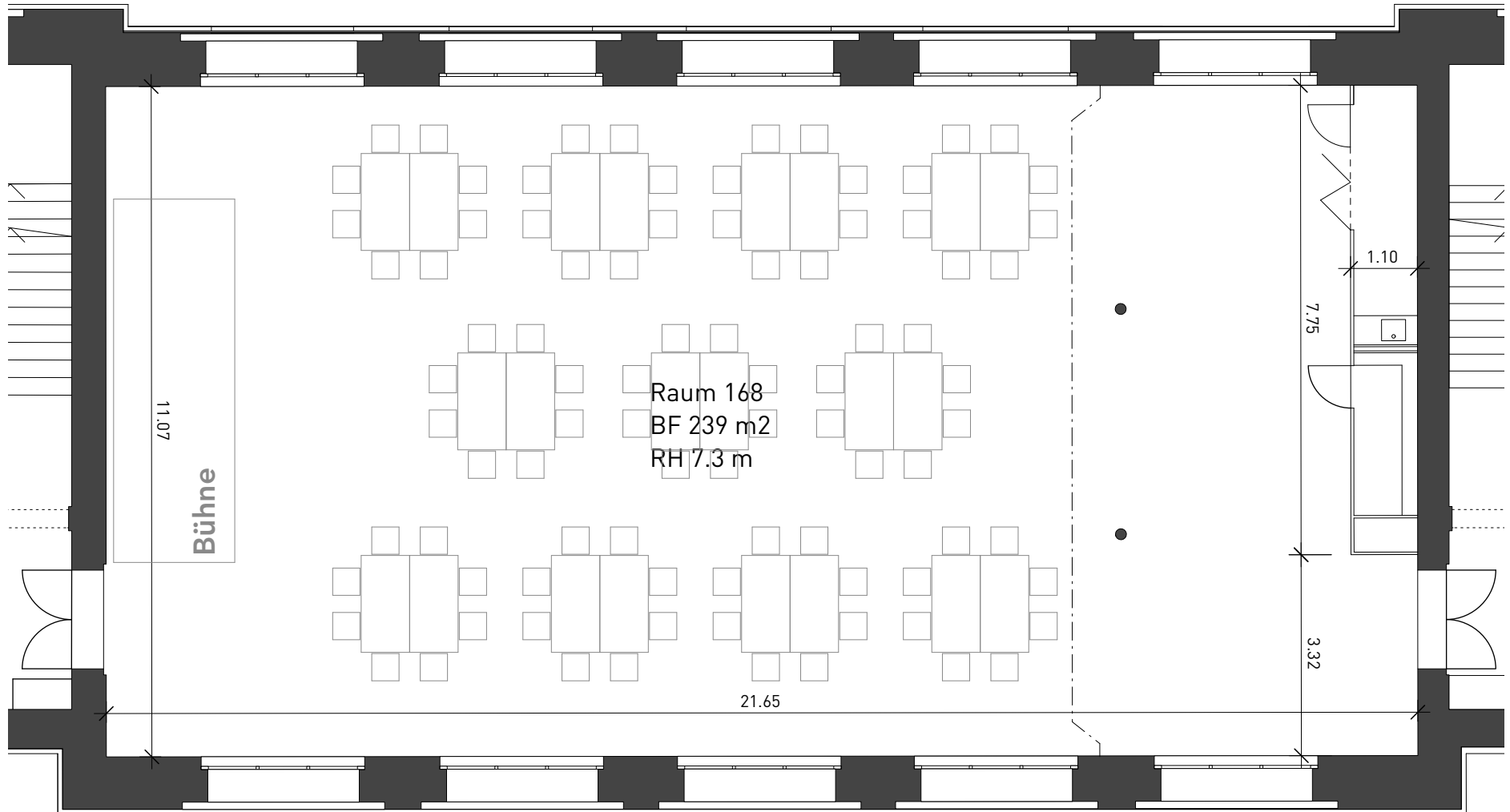

Einrichtung: Tischinseln

Max. 90 Personen

Massstab/Format 1:100 | A4

Plannummer 168.1

Datum 25.06.2020

Gezeichnet LL

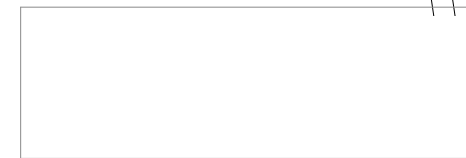
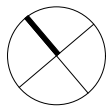

Bühne = 2000x6000cm



Tisch = 160x80cm



Stuhl = 45x45cm

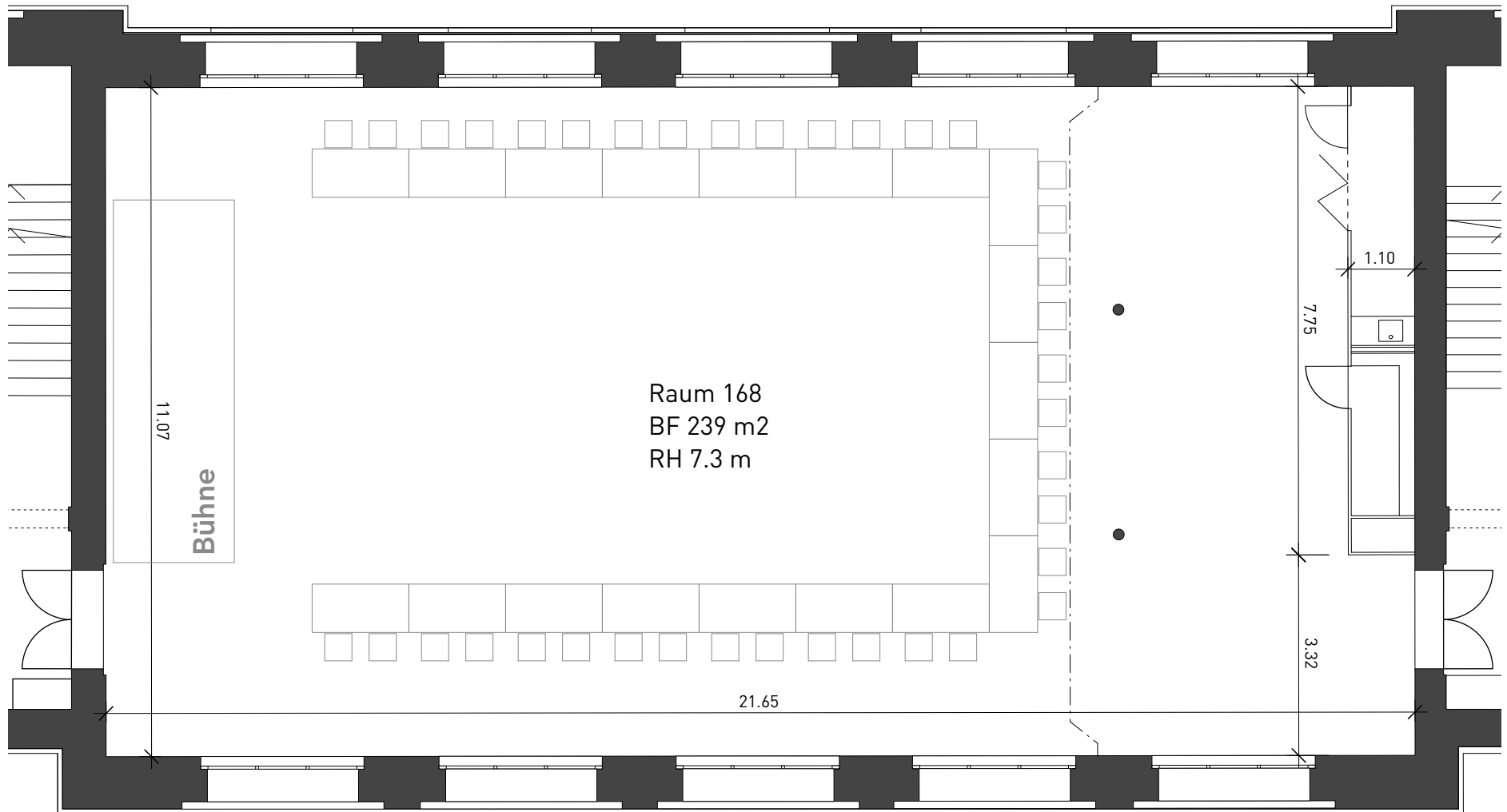

Einrichtung: U-Form

Max. 40 Personen

Massstab/Format

1:100 | A4

Plannummer

168.1

Datum

25.06.2020

Gezeichnet

LL

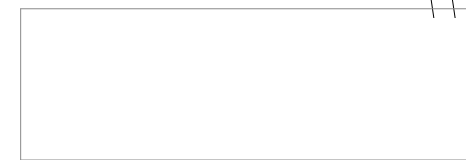
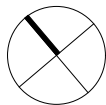

Bühne = 2000x6000cm



Tisch = 160x80cm



Stuhl = 45x45cm